

AUTOMATIC LOAD-CELL SYSTEM BRINELL HARDNESS TESTER

FB-3000LC



HYDRAULIC TYPE
BRINELL HARDNESS TESTER

FB-1



FB-3000LC

Direct loading method with Load-Cell system.

High-speed and high-precision Brinell hardness test is available.

Features

■ Direct loading method with Load-Cell system.

12-steps load switching can be easily operated for 62.5 to 3000kgf. by a button.

■ Load holding time can be selected arbitrarily by 5 to 60 seconds every 5 seconds.

■ Automatic load-hold-release of test load is available.

■ Easy-to-operate front panel.



LED display (Front panel)



Anvil V-shape (Large)
φ 90mm



Tungsten carbide ball
indenter of φ 10mm for Brinell



Tungsten carbide ball
indenter of φ 5mm for Brinell

SPECIFICATIONS

ITEM	SPECIFICATIONS
TEST LOAD	62.5/100/125/187.5/250/500/750/1000/ 1500/2000/2500/3000kgf
LOADING MECHANISM	Load cell type (automatic load / hold / release method)
DWELL TIME	Optional setting for 5 to 60 seconds (with 5 seconds unit)
LOAD DISPLAY	LED display
COMPLIANT STANDARD	In compliance with ASTM-E10, JIS B7724
MAX. SPECIMEN HEIGHT	255mm (with lead screw cover attached: 200mm)
MAX. SPECIMEN DEPTH	170mm
DIMENSIONS	W220×D550×H810mm
WEIGHT	136kg
POWER SUPPLY	AC100/240V (select either one when ordering), 50/60Hz

STANDARD ACCESSORIES

ITEM	QUANTITY
TUNGSTEN CARBIDE BALL INDENTER FOR FB-3000LC	
φ 5mm	1
φ 10mm	1
TUNGSTEN CARBIDE BALL FOR BRINELL	
φ 5mm	1
φ 10mm	1
ANVIL	
FLAT φ 100mm	1
V-SHAPE (LARGE) φ 90mm	1
HARDNESS CALCULATION TABLE	1
MACHINE COVER	1
LEVEL ADJUSTING LEG	4
INSTRUCTION & MAINTENANCE MANUAL	1
POWER CORD (3P- 1800mm)	1
ACCESSORY BOX	1

FB-1

Widely used for many years,
Orthodox hydraulic standard type.

Features

- Traditional simple structure.
With a strong body, no power supply is required.
- By adjusting the dead-weights of
500/750/1000/2000/2500/3000kgf,
the load can be selected arbitrarily.
- Load the test load using a manual hydraulic pump.
- The thrust bearing is built in the lower part of
elevating handle for the smooth elevation.

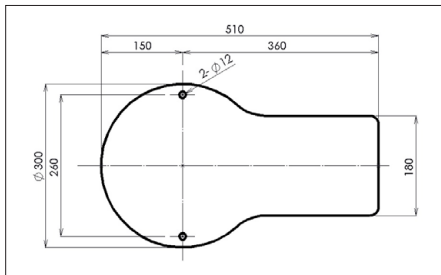

Bottom of the main body (Mounting hole depth about 50mm)



SPECIFICATIONS

ITEM	SPECIFICATIONS
TEST LOAD	500/750/1000/2000/2500/3000kgf
LOADING MECHANISM	Hydraulic type (manual load / hold / release method)
LOAD DISPLAY	Dial gauge
COMPLIANT STANDARD	In compliance with ASTM-E10, JIS B7724
MAX. SPECIMEN HEIGHT	210mm
MAX. SPECIMEN DEPTH	155mm
DIMENSIONS	W430×D510×H1100mm
WEIGHT	165kg (When full weights are attached)

STANDARD ACCESSORIES

ITEM	QUANTITY
TUNGSTEN CARBIDE BALL INDENTER FOR FB-1	1
TUNGSTEN CARBIDE BALL FOR BRINELL	1
ANVIL	1
HARDNESS CALCULATION TABLE	1
MACHINE COVER	1
INSTRUCTION & MAINTENANCE MANUAL	1
SPARE OIL	1
ACCESSORY BOX	1

OPTIONAL ACCESSORIES

ITEM	MODEL	FB-3000LC	FB-1
VARIOUS BRINELL STANDARD BLOCKS FOR HARDNESS		○	○
MEASURING MICROSCOPE X20 FOR BRINELL		○	○
MEASURING MICROSCOPE X40 FOR BRINELL		○	○
MEASURING MICROSCOPE X20 FOR BRINELL (DIAL GAUGE TYPE)		○	○
MEASURING MICROSCOPE X40 FOR BRINELL (DIAL GAUGE TYPE)		○	○
STAGE MICROMETER (FOR VERIFYING MEASURING MICROSCOPE)		○	○
TUNGSTEN CARBIDE BALL INDENTER ϕ 2.5mm FOR BRINELL		○	×
TUNGSTEN CARBIDE BALL ϕ 2.5mm FOR BRINELL		○	×
TUNGSTEN CARBIDE BALL INDENTER FOR BRINELL (With ASTM compatible and UKAS certificate)	ϕ 2.5mm	○	×
	ϕ 5mm	○	○
	ϕ 10mm	○	○
TUNGSTEN CARBIDE BALL FOR BRINELL (With ASTM compatible and UKAS certificate)	ϕ 2.5mm	○	×
	ϕ 5mm	○	○
	ϕ 10mm	○	○
ANVIL FLAT ϕ 60mm		○	○
ANVIL V-SHAPE (SMALL) ϕ 60mm		○	○
ROUND TABLE ϕ 200mm		○	○
ROUND TABLE ϕ 250mm		○	×
ROUND TABLE ϕ 280mm		×	○



Measuring microscope for Brinell(Dial gauge type)



Stage micrometer (for verifying Brinell measuring microscope)



Tungsten carbide ball indenter ϕ 2.5mm For Brinell



Various Brinell standard blocks for hardness

※ Appearance and specifications are subject to change without prior notice for the product improvement.



FUTURE-TECH CORP.

<http://www.ft-hardness.com>

HEAD OFFICE

TALKPIER KAWASAKI BLDG., NO. 5-1, 3-CHOME, FUJISAKI,
KAWASAKI-KU, KAWASAKI, KANAGAWA, 210-0804 JAPAN
TEL. +81-44-270-5789 TEL. +81-44-266-6779
E-mail: info@ft-hardness.com

EUROPEAN REPRESENTATIVE OFFICE:

VIA MATTEOTTI 23/E, 20090 ASSAGO(MILAN),ITALY
TEL/FAX: +39-02-91669470 MOBILE. +39-335-1803592
E-mail: cantoni.fte@gmail.com

FUTURE-TECH (ASIA) CO., LTD. :

777/11 MOO 9, BANGPLA, BANGPLEE,
SAMUTPRAKARN 10540, THAILAND
TEL: +66-2-136-6281 FAX. +66-6-136-6282
E-mail: siripong@ft-hardness.com



We are based on JIS Q 17025 (ISO/IEC 17025) as accredited standards, and accredited by JCSS who manages the recognition scheme according to ISO/IEC 17011. IA Japan (accreditation organization who has managed JCSS) who is signatory to the Mutual Recognition Arrangement (MRA) of International Laboratory Accreditation Cooperation (ILAC) and Asia Pacific Accreditation Cooperation (APAC). We are accredited as MRA Calibration Laboratory of JCSS. Our accreditation number is JCSS 0228.

